

Vibration Transducer SLD122A / SLD122E

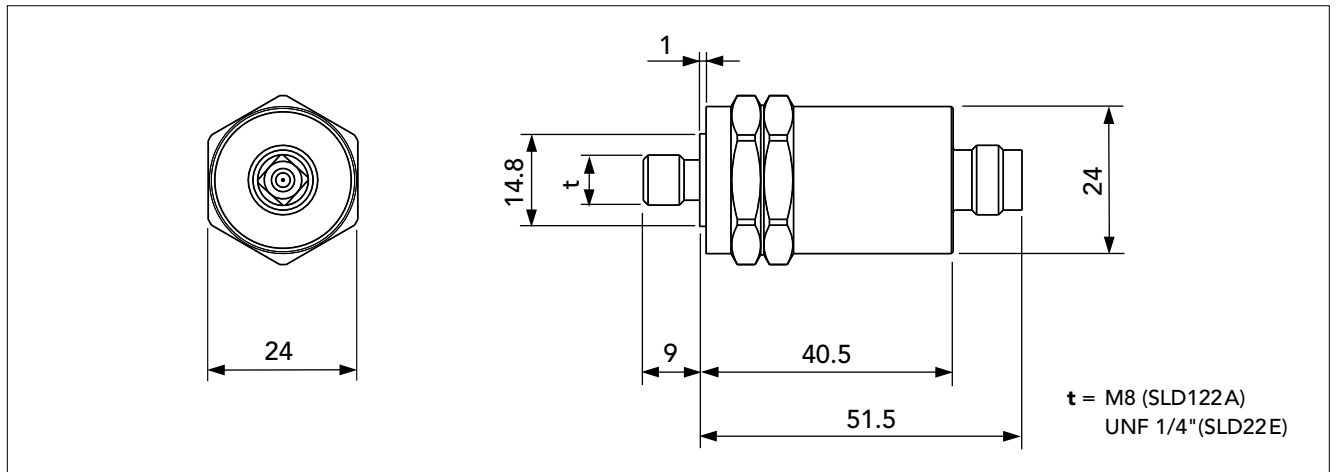

The vibration transducers SLD122A and SLD122E are piezo-electric accelerometers of compression type with built-in preamplifier, designed for vibration monitoring of industrial machinery. The electrical signal is isolated from the transducer housing.

The transducer is mounted against a smooth, flat surface on the machine. SLD122A has thread size M8 and SLD122E has thread size UNF 1/4". The transducer is connected via a coaxial cable (SPM 90005-L or 90267-L) with SMB connector.

Technical data

Nominal sensitivity, main axis:	4 mV/m/s ² * = 40 mV/g
Transverse sensitivity:	max. 10%
Typical base strain sensitivity:	0.01 m/s ² /μ strain
Linear frequency range:	2 to 5000 Hz (± 1 dB)
Max. peak acceleration:	600 m/s ² = 60 g
Settling time:	3 sec
Bias point:	6 to 9 V (typical 8) V
Temperature range:	-40° C to +125° C (-40° F to 260° F)
Power requirements:	12 to 24 V, 2 to 5 mA
Casing:	Stainless acid proof steel
Sealing:	IP 67 together with connector SPM 15388, 14990 or 15164
Isolation:	Case isolated, > 1 Mohm
Torque limit:	10 Nm (7.4 lbf·ft)
Weight:	110 grams (4 oz)
Connector type:	SMB

* Individual value given on the calibration chart.

Mounting tools

- 81027 Holder for counterbore
- 81057 Counterbore, diameter 20 mm
- 81030 Pilot for UNF 1/4"
- 81031 Pilot for M8

To drill the mounting hole, use drill bit 6.9 mm (M8) or 5.5 mm (UNF 1/4"). Torque the transducer with a 24 mm torque wrench.

